

BASE PROTOCOL FOR EXHALE

General set-up



Example object for this base protocol

A normal apartment around 40-80 SQM with a normal sized bedroom or living room (10 - 30 SQM). Please be aware that this is only a general protocol. Every bed bug case is different, so you might need to use more Exhales, or place them differently. We can be helpful if needed.

General rules

- Do not face Exhale towards yourself at any point
- Use safety glasses while operating Exhale
- You should go out of the area/room where Exhale is being used. If there are people staying there for longer time periods while Exhale is operating, the bed bugs can be distracted.

N.B. When you set an interval for the first time, Exhale will perform a test spray to ensure the device is working properly.

How to set mode, interval and insert the Exhale Aerosol

Watch me for instructions: <https://www.youtube.com/watch?v=Y8y0ufZ4MBU>

N.B. An easier way to insert the aerosol is to take the front cover completely off, as shown in the picture below.



General stats when operating Exhale

Amount of sprays in one aerosol: Ca. 90

Example: Operativ 24h Modus

5min interval: 7,5 hours

10min interval: 15 hours (recommended)

15min interval: 22,5 hours (recommended)

20min interval: 30 hours

Example: Operativ Night Mode (Measured with 7 hours of darkness)

5min interval: 1 night

10min interval: 2 nights (recommended)

15min interval: 3 nights (recommended)

20min interval: 4 nights

Recommended settings on the Exhale dispenser

24H Interval:

- Set the spray interval to 10 min.
- Exhale will now perform for 15 hours on one aerosol.
- You can safely leave the Exhale operating without supervision during evening/night time, so you can come back the next day to have a check.

At this time interval, you might need 2 aerosols equal to 30 hours in total, for more optimal findings. Do not change the Exhale position the first 15 hours during monitoring.

Night Mode (Highly Recommended):

Only operates when it is dark

- Set the spray interval to 15 min.
- Exhale will now perform for 3 nights on one aerosol (Estimated with 7 hours of darkness per night).
- You can safely leave the Exhale operating without supervision during evening/night time.
- Make sure it will be dark in the room

Do not change the Exhale position the first 2 nights of operating.

Make sure the room does not get a lot of light in from the streets outside or other light objects after the sun goes down.

TIPS: You can also use a lamp with a timer facing the Exhale dispenser while having it on night mode, if you want to have more control over the spray intervals and length of the night. The sensor will make the Exhale not spray as long as it is noticing light.

Placement

- Make sure the Exhale is facing the infested areas in the room, but also give it enough space so it is able to spray CO2 and pheromones in the whole room (see example picture from a real case below)

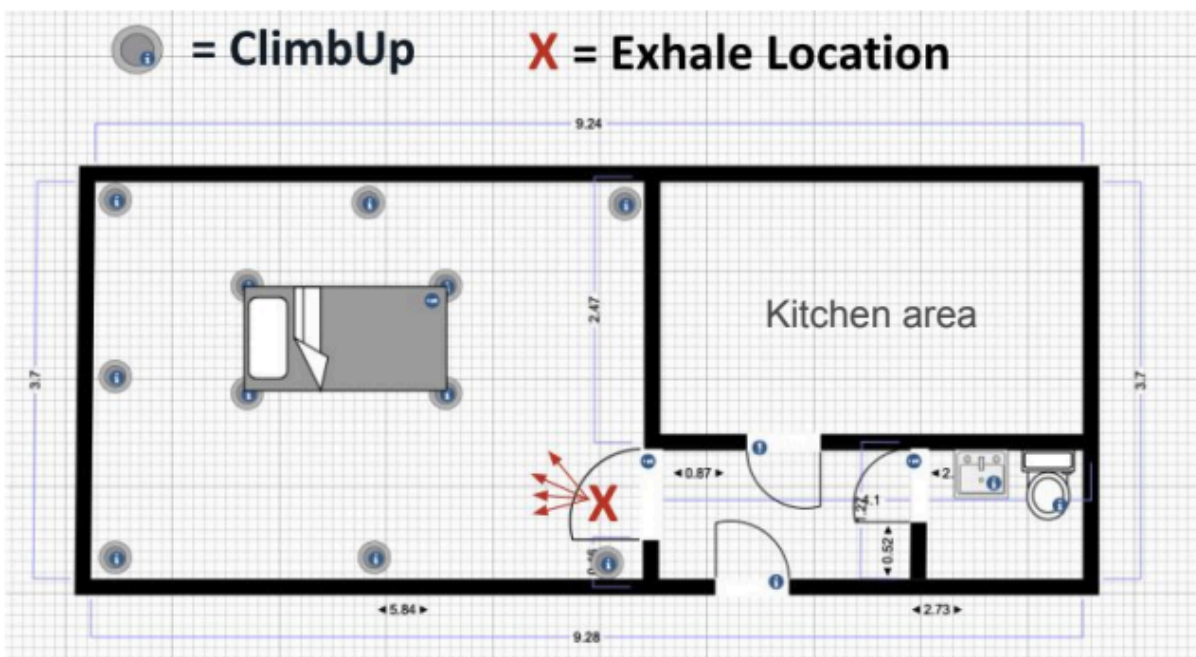

In the case above, the bed was the most infested area, but there were also a lot of bed bugs found in the skirting boards. We let the Exhale spray into the whole room, but facing the bed.

NB: You must place traps around in the room as shown in the picture above, to be able to monitor effectively. ClimbUp is a good choice.



You can also put two sided tape around the Exhale, in case of bed bugs approaching the device. Red dots show Bed bugs caught during a case study.

Source of sorting

Exhale Aerosol

The Aluminium is sorted as metal

The ventill is sorted as plastic

The Spray nozzle is sorted as plastic (made of HDPE - high density polyethylene)

Exhale Dispenser

Hook off the inside electric device, and sort it as electric waste

Sort the remaining cover as plastic

Dispenser user manual below ↓

User Manual

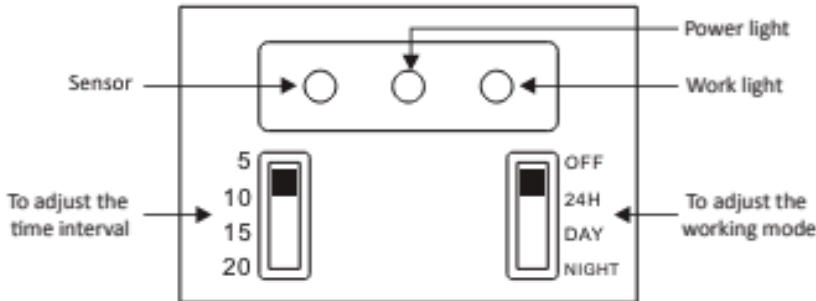

Sensor:
The dispenser senses the light, will not flash.

Power light:
After the dispenser is turned on, green light flashed every second.

Work light:
When dispenser is about to spray, red light and green light flash.

INSTRUCTIONS:

Step 1: Open the machine cover by pressing the grey top button

Step 2: Install two "D" batteries in the battery compartment

Step 3: Select the operating working mode

1. Adjust the working mode

- 24H Dispenser operates at selected spray interval for 24 hours. (Recommended)
- DAY Dispenser operates at selected spray interval in lighted conditions only. (eg: sunshine/light)
- Night Dispenser operates at selected spray interval WITHOUT lighted conditions. (eg: No light at night)

2. Adjust the time interval

5, 10, 15 or 20 minute intervals can be selected.

Step 4: Installing Exhale

Place the "neck" of the Exhale can at the snap position of the dispenser tightly. Gray metal part on Exhale needs to be placed above the metal holder in the dispenser.



Note: Before installing the can, make sure the hammer is in the "UP" position. If not, adjust the hammer to "UP" position by using a pen or key to push the hammer gently.

When Exhaled is installed, do not face the dispenser towards yourself or others. Once the working mode is changed, this will trigger the hammer and the first spray will be carried out.

In case of carelessness, please rinse with water immediately. In case of illness, visit doctor. More information about safety measurements when operating Exhale is found in the Safety Data Sheet.



Error: Hammer is exposed
Dispenser will not spray if the can is installed in this situation

Correct:
Exhale can be installed in this situation. The hammer is not visible.

Step 5: Setup is complete

Close the cover and place the dispenser in suitable location. If preferred, lock the cover by inserting the included lock into the hole found in the right side of the dispenser.