

Step-By-Step Assembly Manual

for Multi bird nest box entry holes

Figure out these on your own or follow the steps of instructions!

TOOLS NEEDED:



1

You can see three different wooden entry holes inside the Multi bird nest box. Put your hand inside the nest box to reach the wooden entry holes.

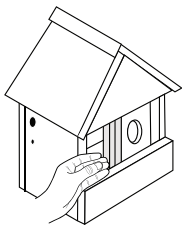

2

Press the first two wooden holes to the side of the Multi bird nest box (vertically).

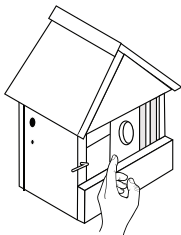

3

Slide the desired wooden hole down and pull at an angle through the opening hole in the Multi bird nest box. Then pull out easily. The other two wooden holes inside the Multi bird nest box pull out easily without any additional action.

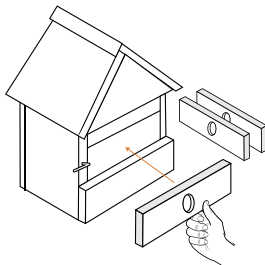

4

After pulling out all the wooden holes, select the most suitable one according to the size of the hole and attach it to the front of the Multi bird nest box.

